

# A user-centred approach to digital health

---

Prof.Vassilis Kostakos  
School of Computing and Information Systems  
University of Melbourne

Presented 25 Oct 2024  
RMIT, Melbourne, Australia

# Human-Computer Interaction

Computing  
Psychology & Social Sciences  
Design

**Mission:**  
**Create the next generation  
of Interactive Technologies**

# Designing technology

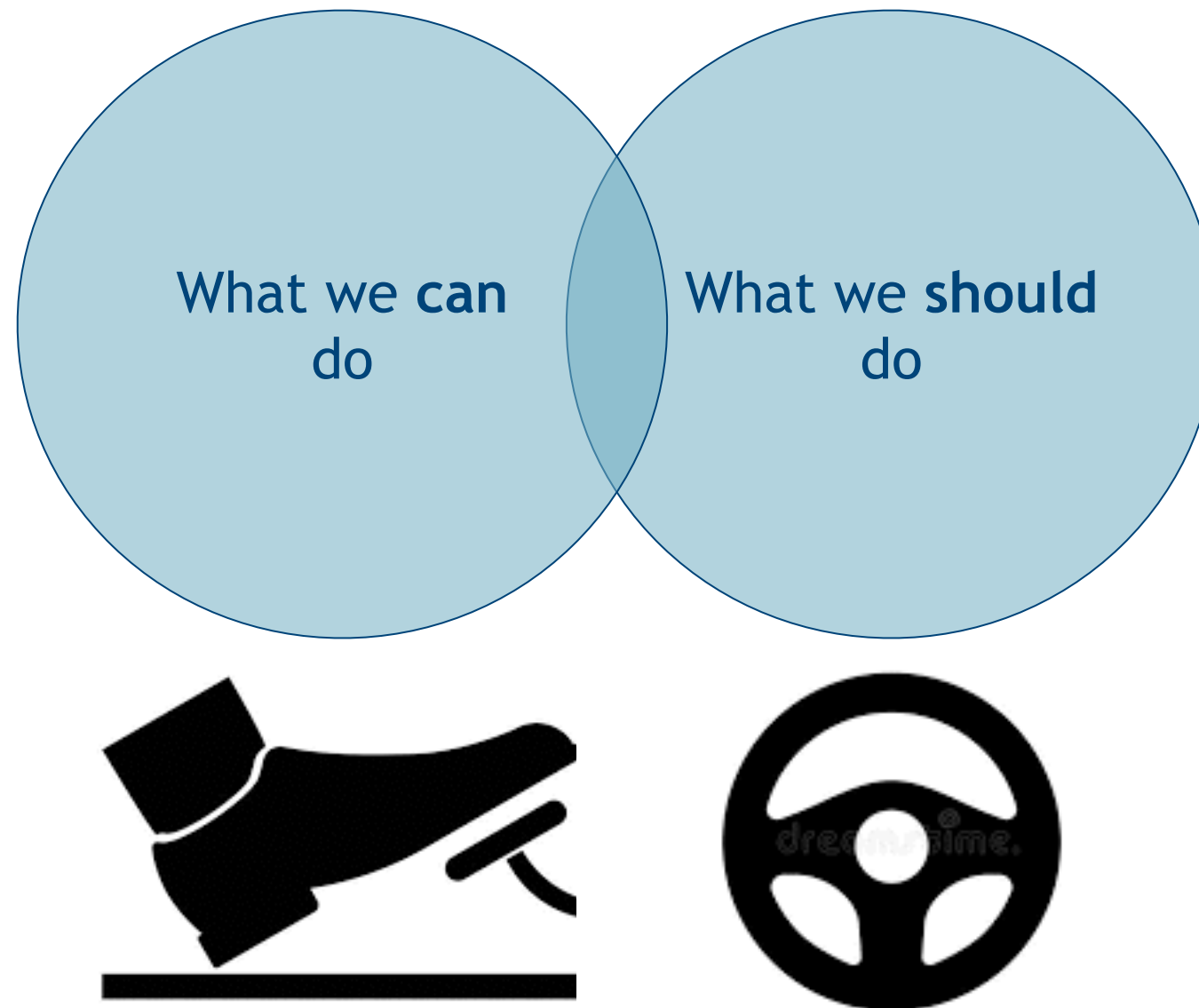

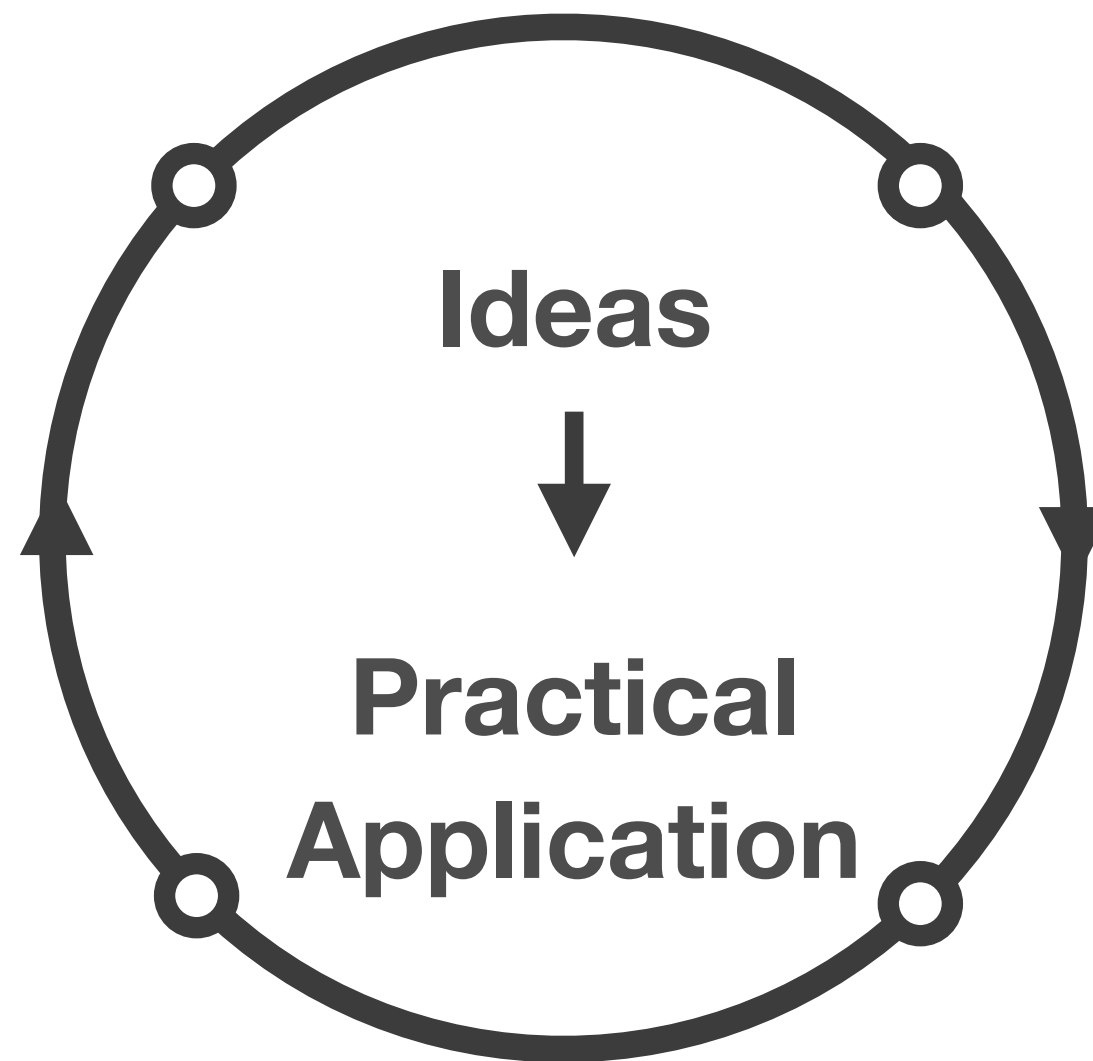





## Smart pill box

### Identify pills using chemical signatures

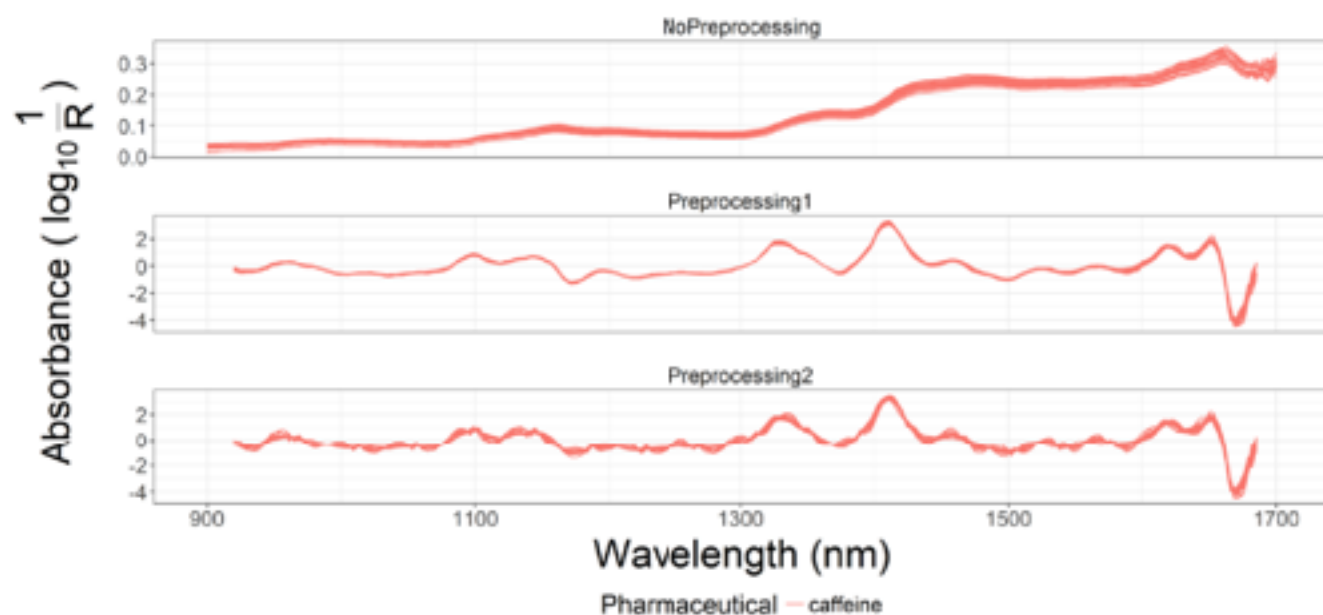
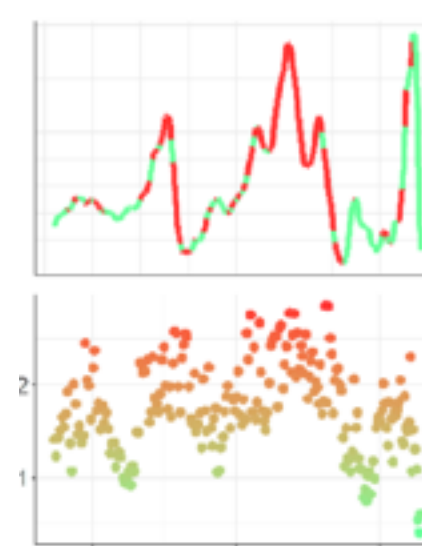
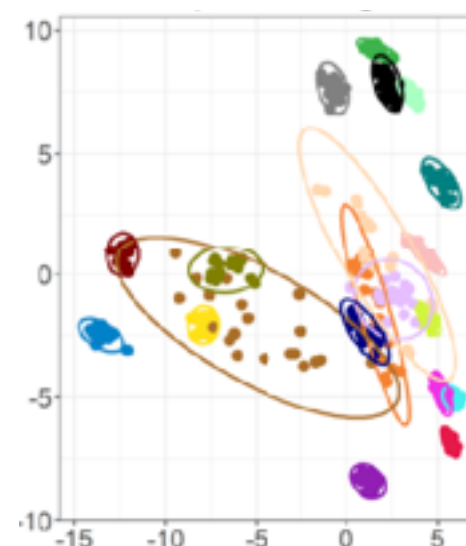
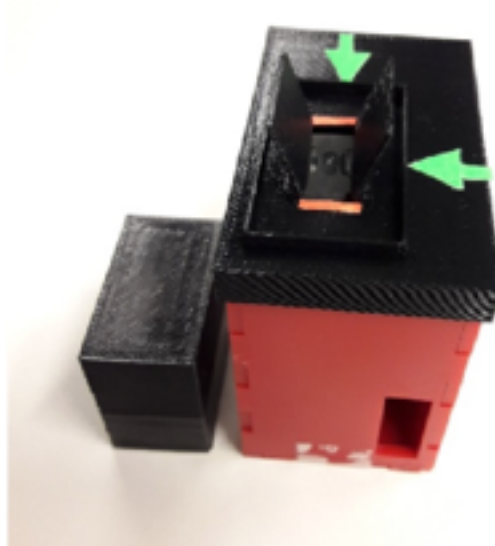









# IV line monitoring Continuous identification of liquids/concentrations in IV line

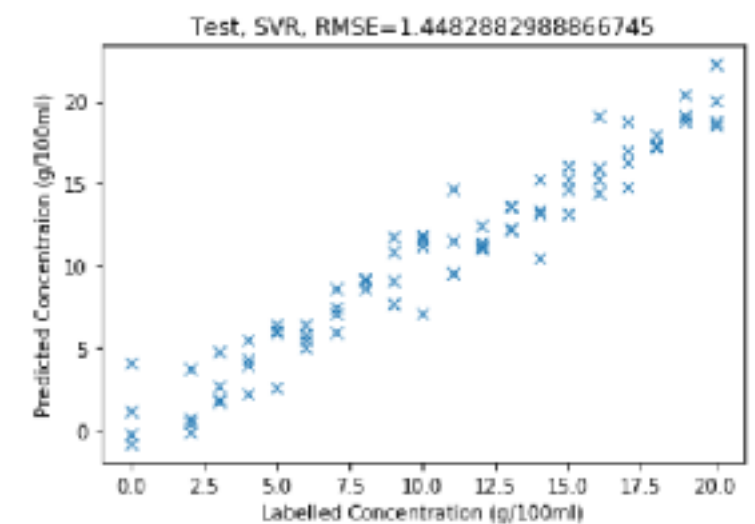
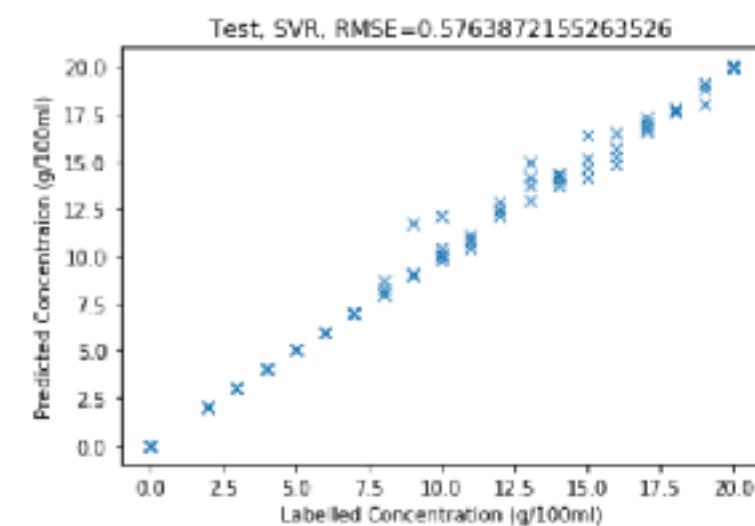
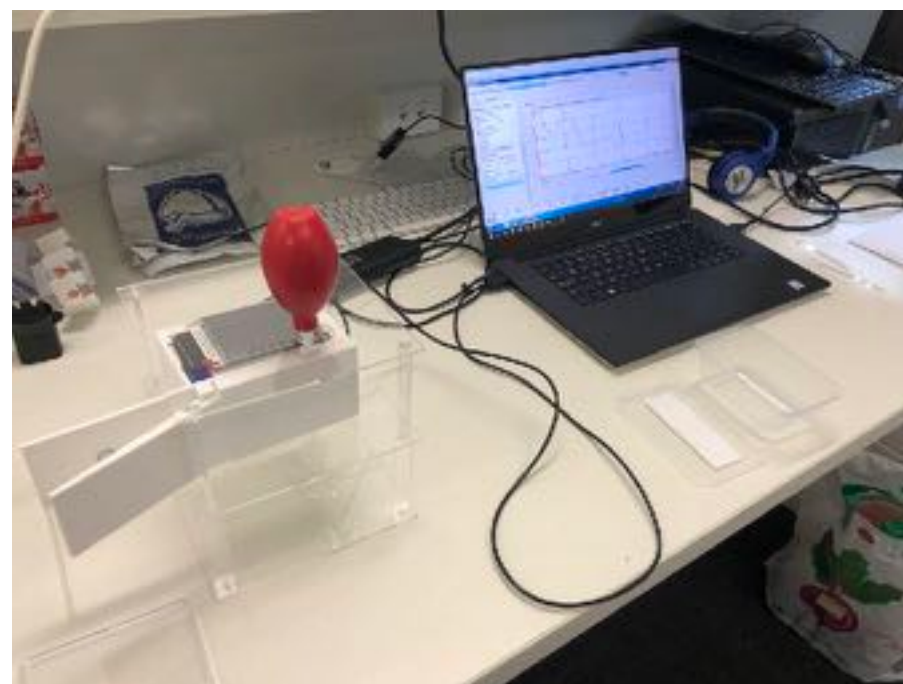
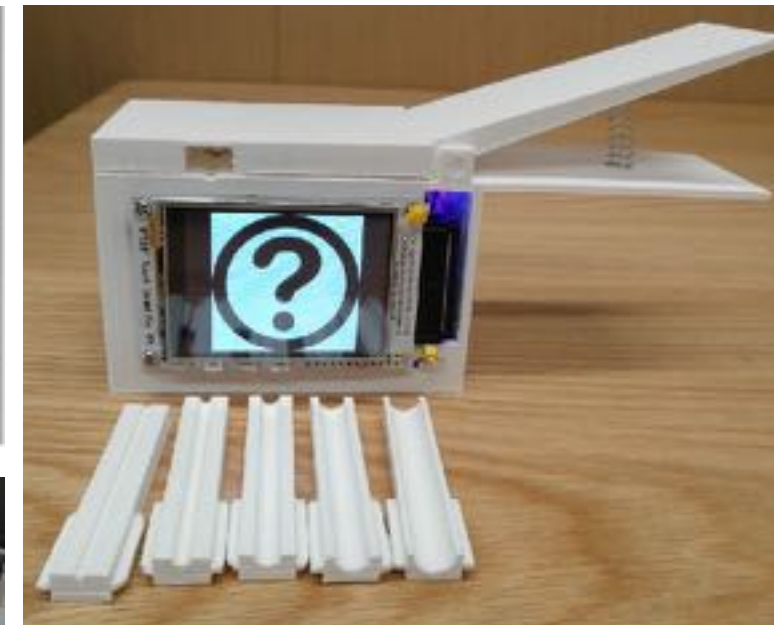
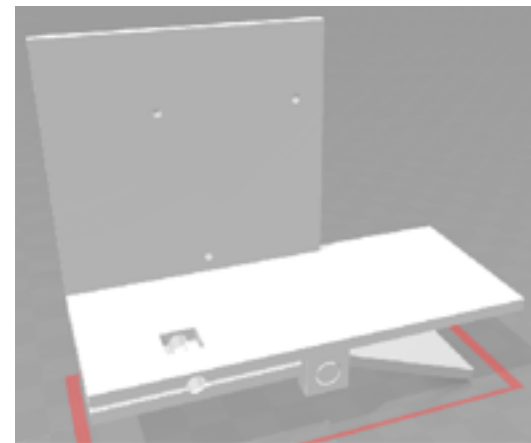



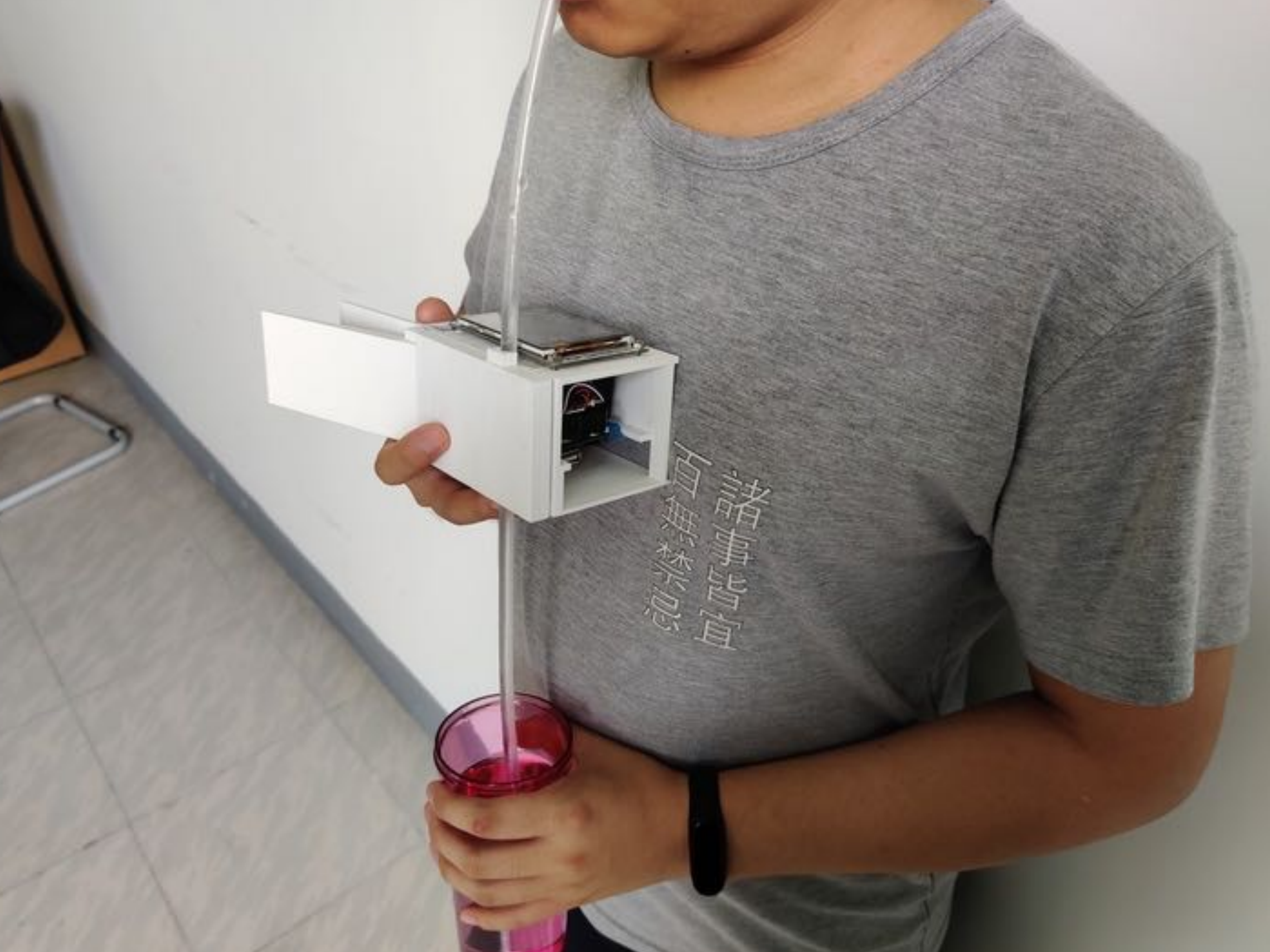



## Operating theatre tracking

Track patients/staff in & out of operating theatres

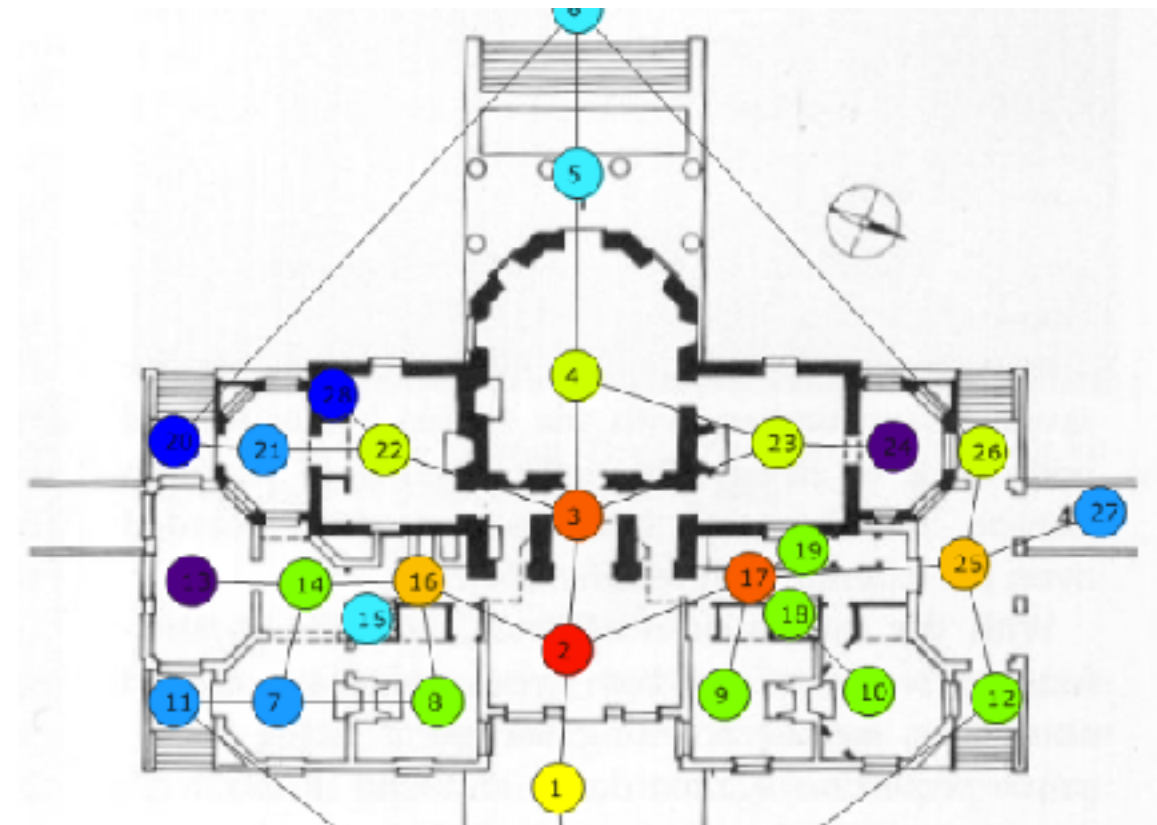
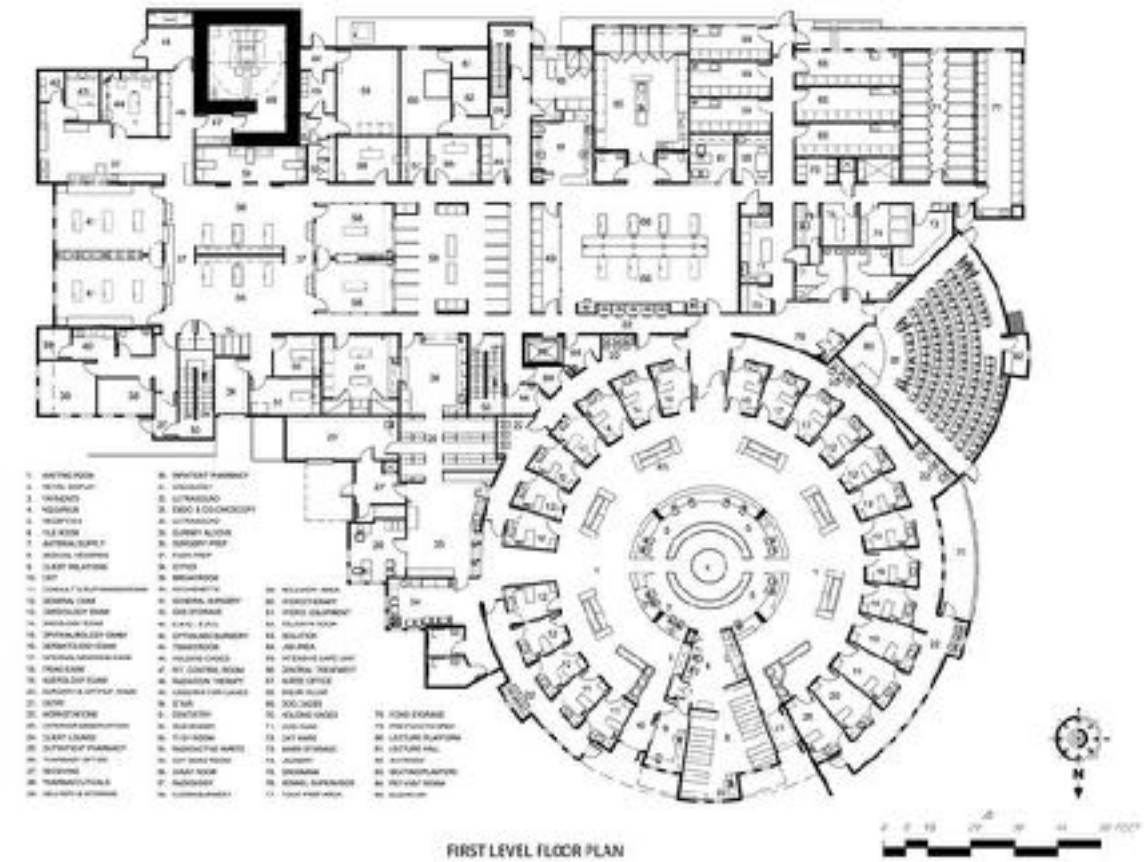

























## Hand washing detection

### Detect (and quantify) hand washing in the hospital

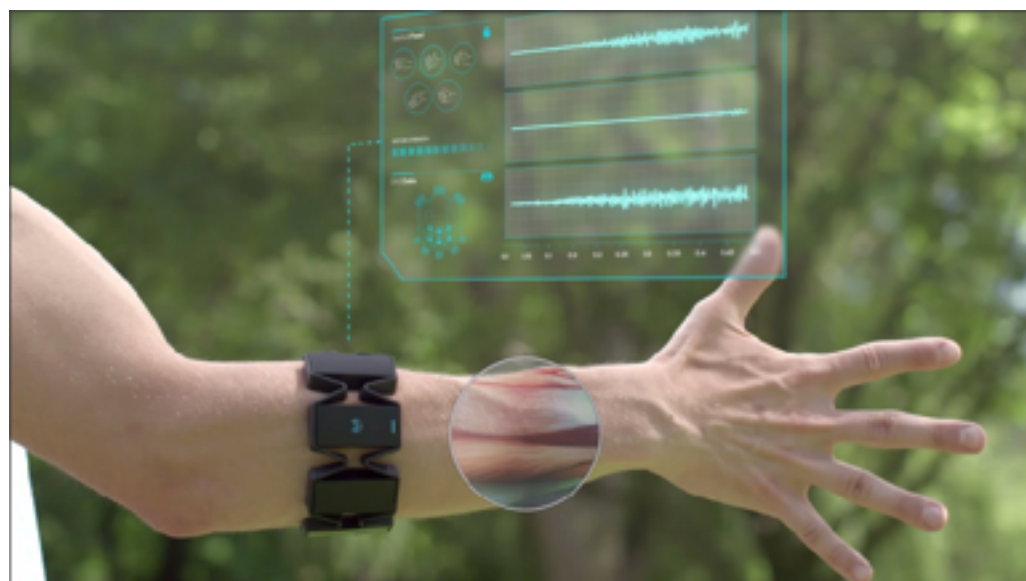
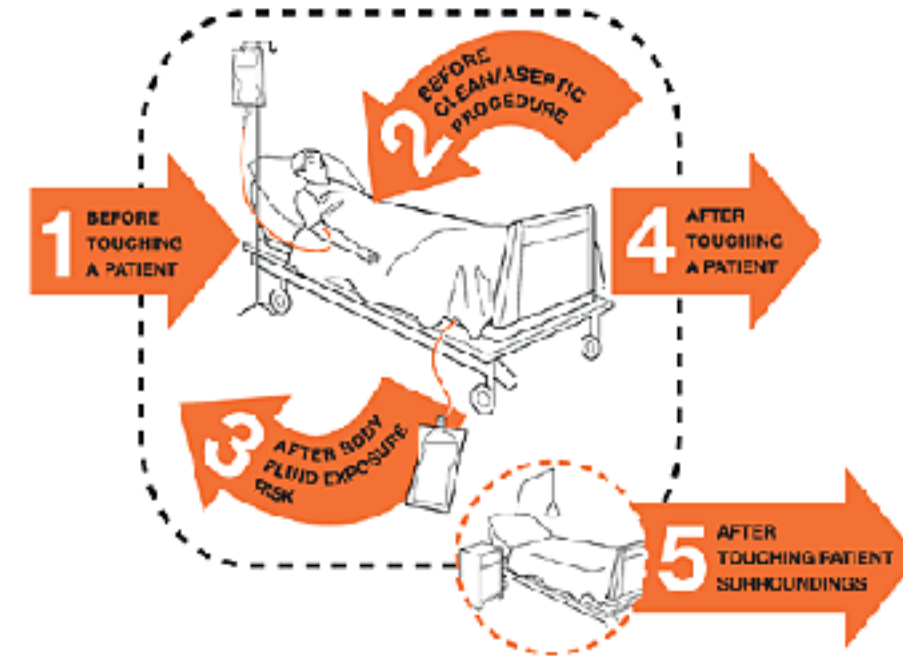













## Hand Hygiene History



Record - 21

Active Now

Good completeness of hand washin...



Record - 20

5 mins ago

You missed some steps when last h...



Record - 19

5 hours ago

There are some steps you need to i...

[Read More](#)

## Summary

01

02

03

04

05

06

07

08

09

10

11

01

Wet your hands with water

Completeness: 50%

02

Apply Soap to cover all hand surf

Completeness: 100%

03

Rub hands palm to palm

Completeness: 70%

04

Right palm over left dorsum with  
Interlaced finger and vice versa

Completeness: Missed

06

Backs of fingers to opposing palm  
with fingers interlocked

Completeness: 100%

05

Palm to palm with fingers interlac

Completeness: Wrong Order

07

Rotational rubbing left thumb clas  
in the right palm and vice versa

Completeness: 50%

08

Rotational rubbing, backwards and  
forwards with clasped fingers of right  
hand in left palm and vice versa

01

Wet your hands with water

Completeness: 50%

## Description

This is the first step from the standard hand washing process from WHO; however, it seems like you may need to prolong the duration of hand washing.

## Standard Procedure



# How to handrub? WITH ALCOHOL-BASED FORMULATION

# How to handwash? WITH SOAP AND WATER

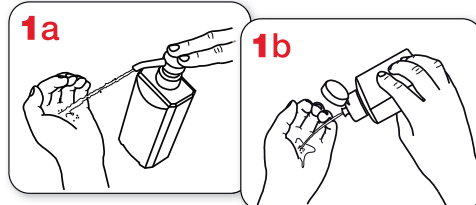

Apply a palmful of the product in a cupped hand and cover all surfaces.

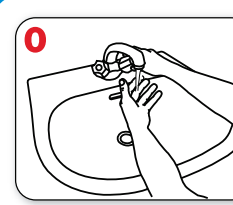

Wet hands with water

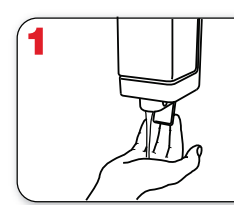

apply enough soap to cover all hand surfaces.



Rub hands palm to palm

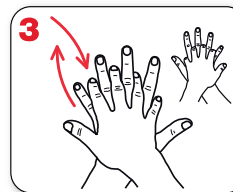

right palm over left dorsum with interlaced fingers and vice versa

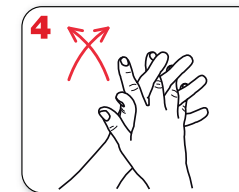

palm to palm with fingers interlaced

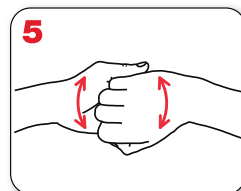

backs of fingers to opposing palms with fingers interlocked

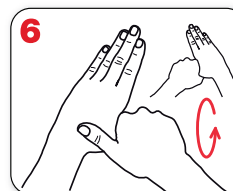

rotational rubbing of left thumb clasped in right palm and vice versa



rotational rubbing, backwards and forwards with clasped fingers of right hand in left palm and vice versa

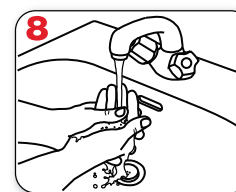

rinse hands with water

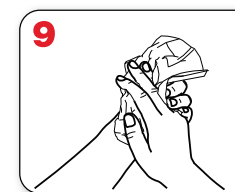

dry thoroughly with a single use towel

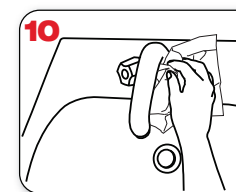

use towel to turn off faucet



20-30 sec

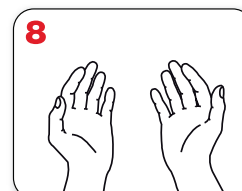

...once dry, your hands are safe.



40-60 sec

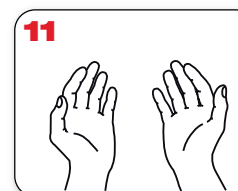

...and your hands are safe.

Design: monodragis network



THE UNIVERSITY OF  
MELBOURNE



WHO acknowledges the Hôpitaux Universitaires de Genève (HUG), in particular the members of the Infection Control Programme, for their active participation in developing this material.



World Health  
Organization

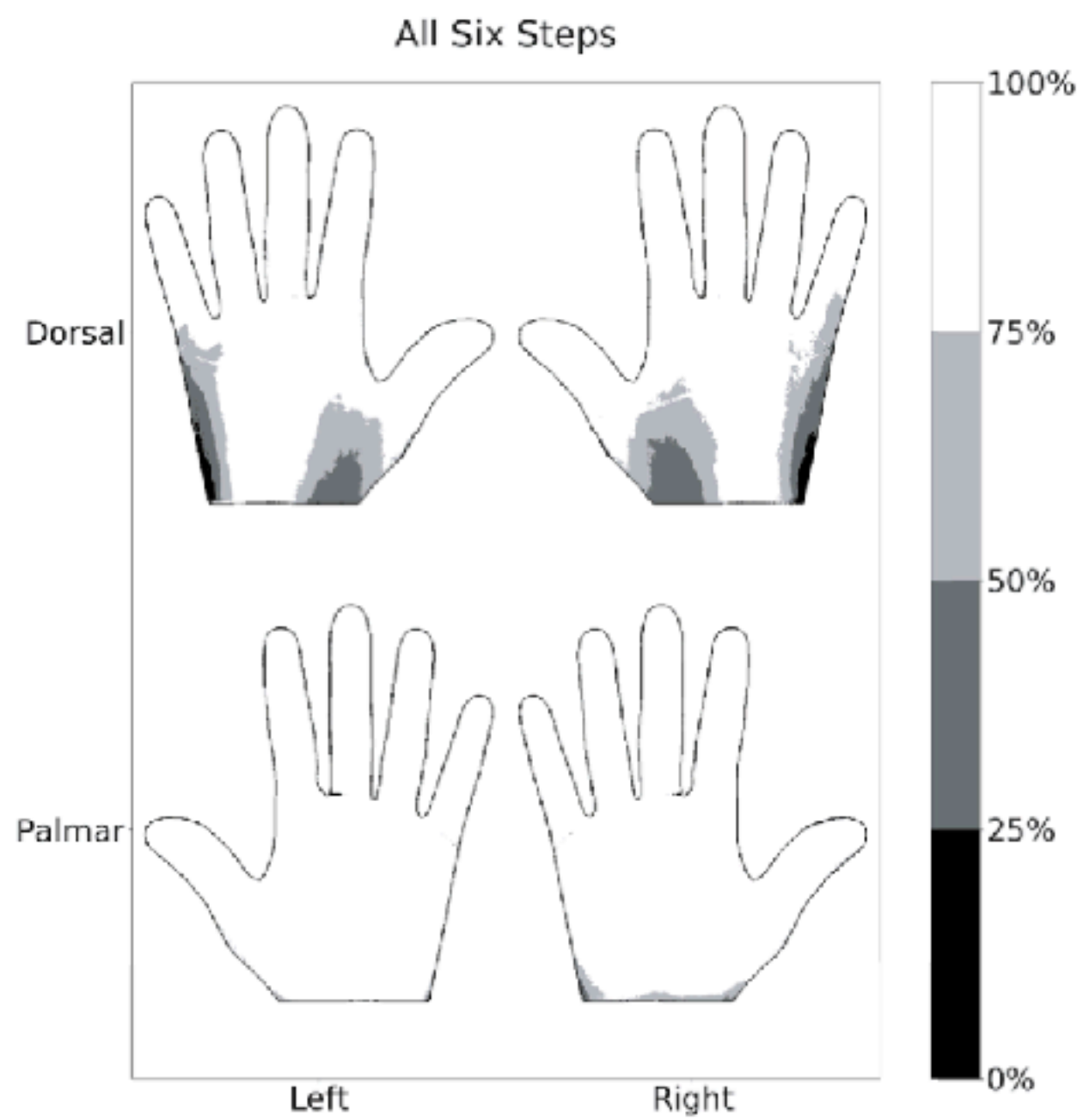



# What's next?

# Large Language Models: empowering the study of human behaviour



Measurement

Phenomena



Sample data

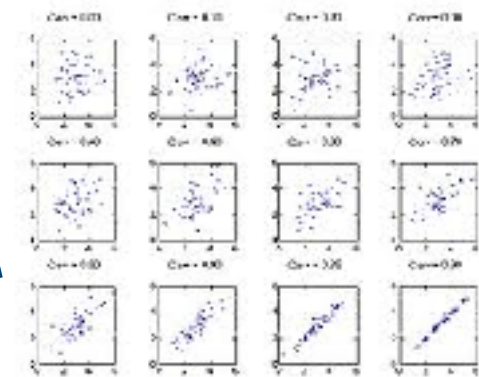

Analysis/Statistics

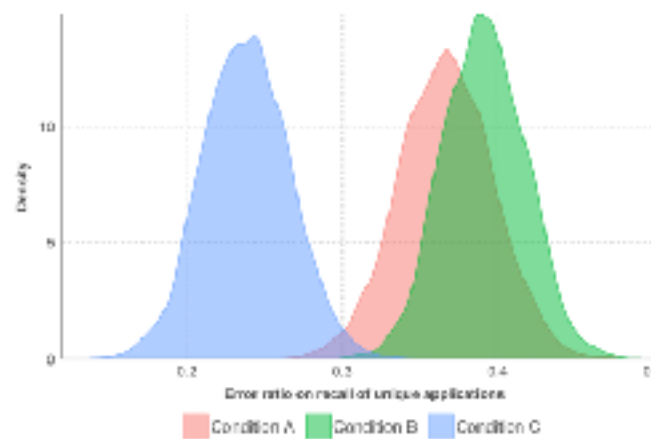

# Modus operandi



Smartphone/Sensors



Calculate metrics

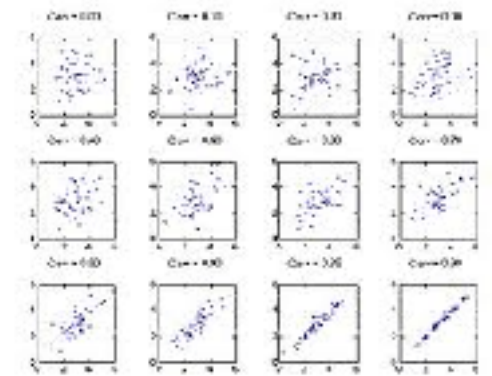

Establish correlations  
Describe behaviour



Behaviour, attitudes,  
questionnaires, etc.



Calculate metrics

## Sources

Social Media  
Smartphone use  
Smart city  
Interaction



## Insights

Happiness  
Personality  
Habits  
Exposure

## Methods

Smartphone sensing  
Crowdsourcing  
In-the-wild methods

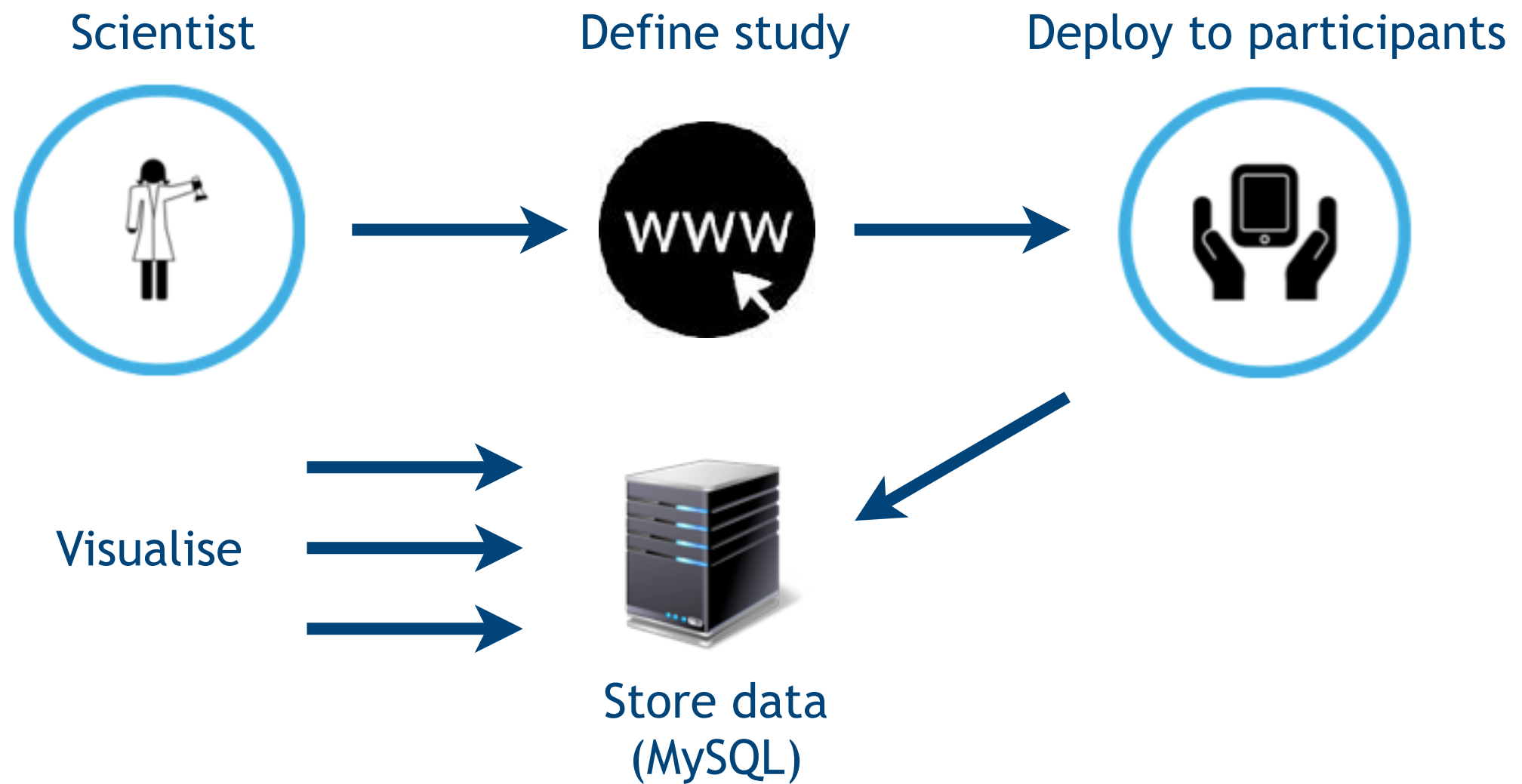

<https://www.aware-light.org>



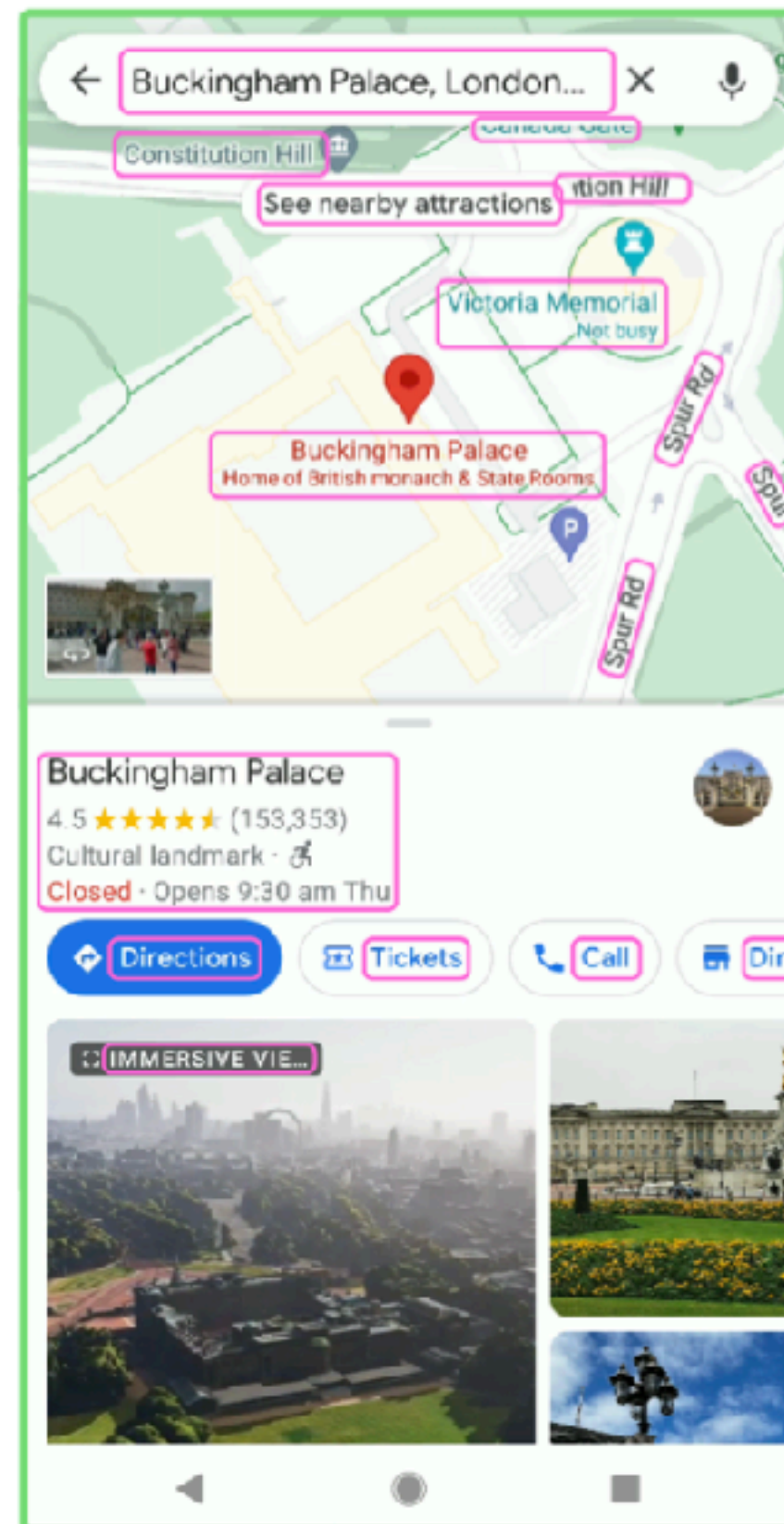
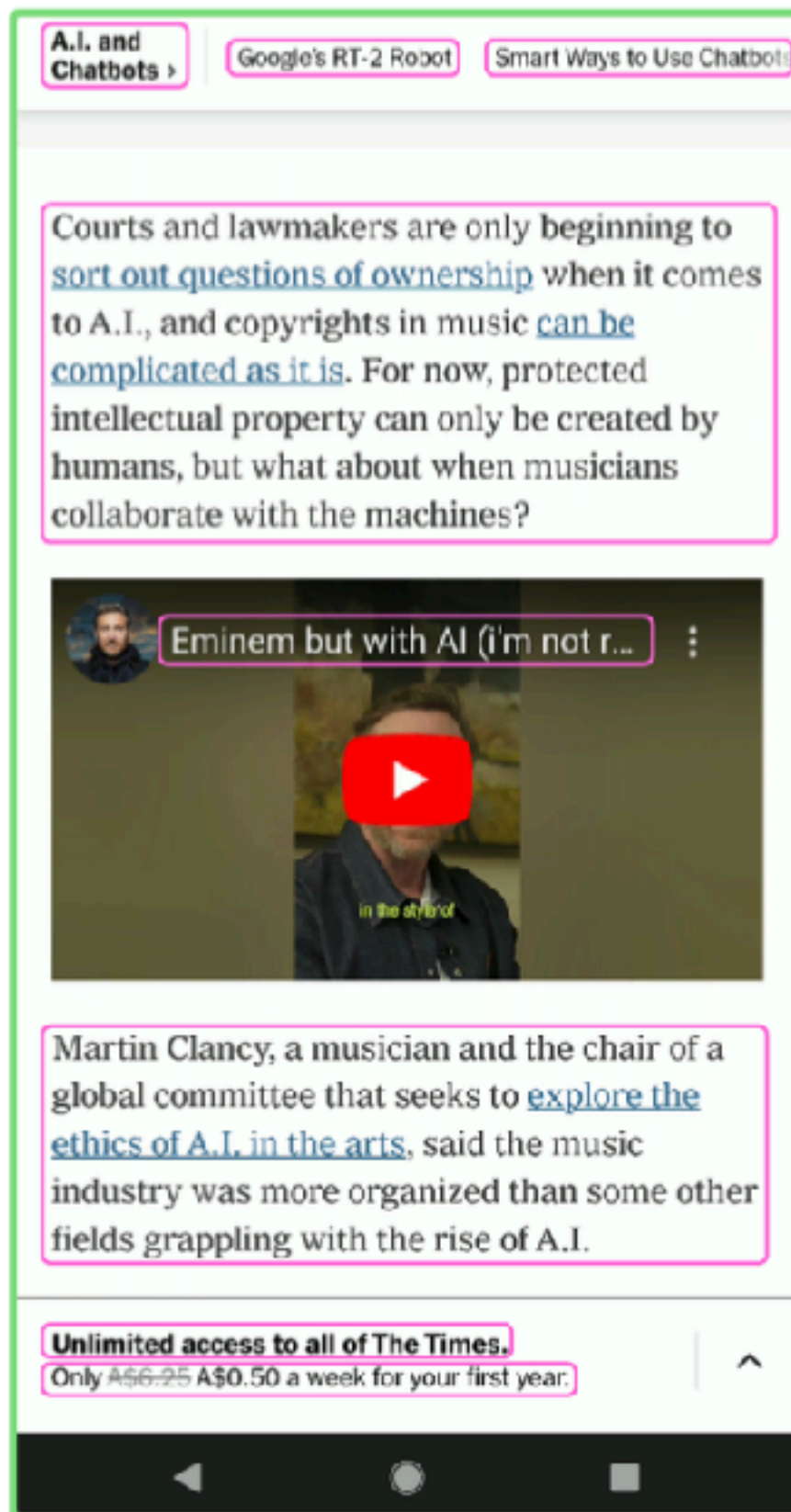

Word	Count
relevant	1070
unit	856
teaching	758
lecturer	689
information	642
accounting	535
professional	535
academic	535
cyber	535
security	535

**App: SEEK (Job-Finding)**  
**(All Participants)**

Word	Count
cal	11348
km	7875
distance	5473
set	5057
heart	4995
sleep	4949
hr	4811
fitbit	4793
rate	4162
2023	4100

**Category: Health**  
**(All Participants)**

Word	Count
taylor	3964
swift	3248
version	1832
playlist	1749
red	1628
loving	1174
english	980
never	927
chou	879
g.e.m	860

**App: Spotify (Music)**  
**(P8)**

Word	Count
foo	3197
fighters	3197
bon	3031
jovi	3016
led	2490
zeppelin	2490
remaster	1747
jukebox	1594
postmodern	1592
rock	1346

**App: Spotify (Music)**  
**(P11)**



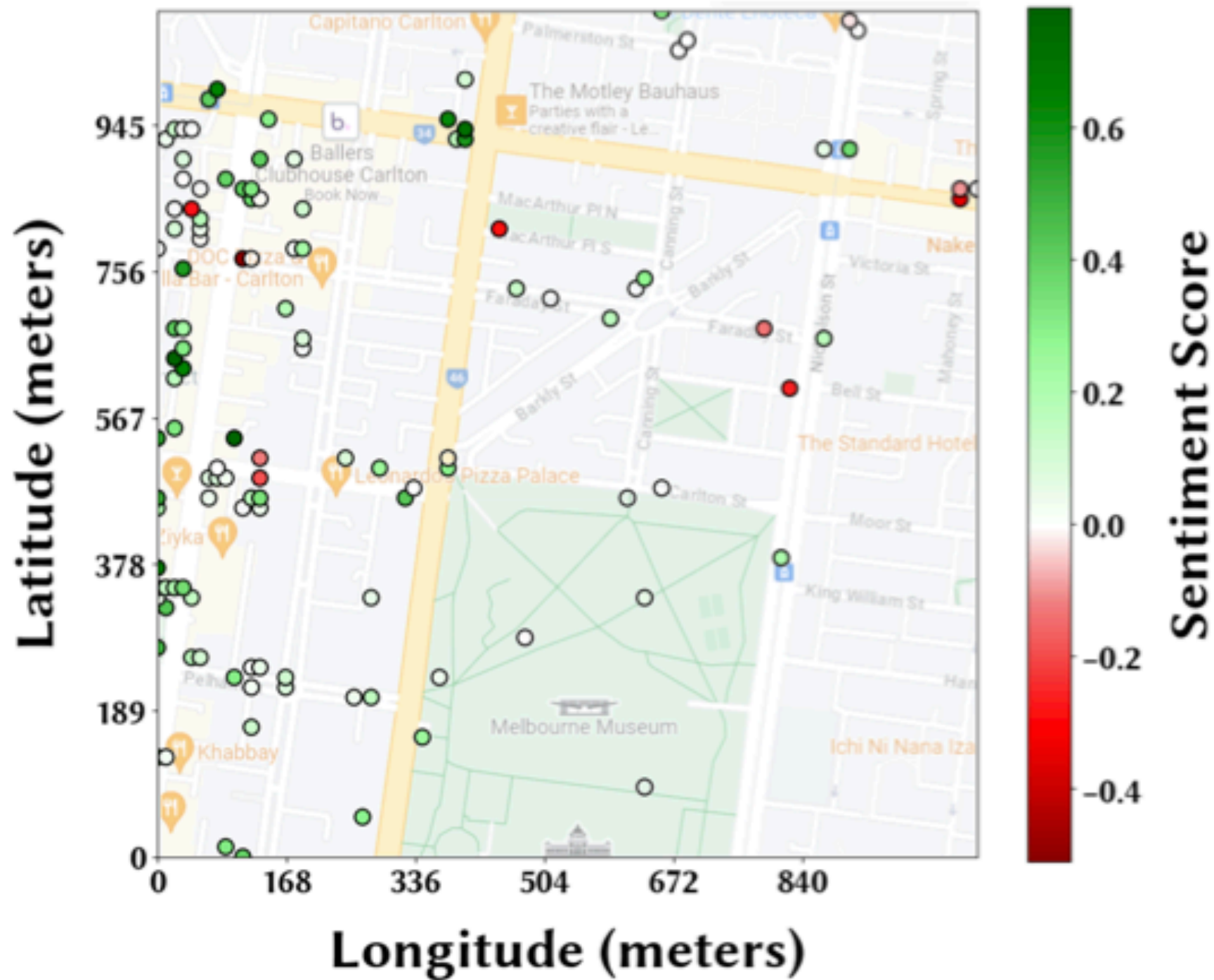

**(a) Average sentiment.**

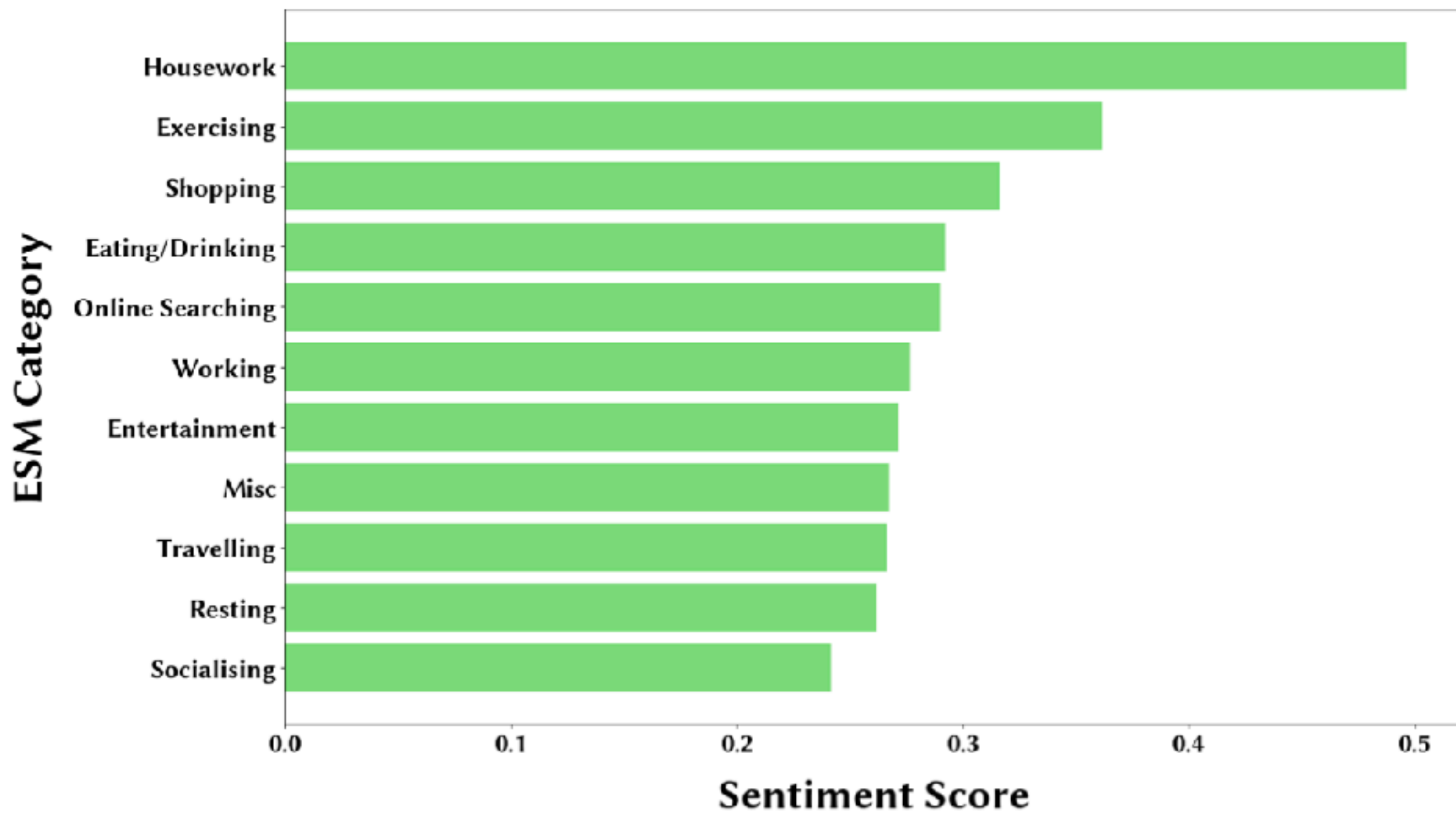

Here are the sentiments of text that a university student has viewed on their smartphone for each day over a week. The sentiments range from -1 to 1, with -1 being most Negative and 1 being most Positive.

Your task is to rate how the student felt for each of the following feelings based on the sentiments of the text they have viewed:

Active

Determined

Attentive

Inspired

Alert

Upset

Hostile

Ashamed

Nervous

Afraid

For each feeling, choose a Likert score ranging from 1 to 5 that best represents how the student generally felt during the week, where 1 represents Never and 5 represents Always.

Sentiments of text the student has viewed on their smartphone over a week:

Day 1: {sentiment of text viewed on the first day of the week}

Day 2: {sentiment of text viewed on the second day of the week}

Day 3: {sentiment of text viewed on the third day of the week}

Day 4: {sentiment of text viewed on the fourth day of the week}

Day 5: {sentiment of text viewed on the fifth day of the week}

Day 6: {sentiment of text viewed on the sixth day of the week}

Day 7: {sentiment of text viewed on the seventh day of the week}

When predicting information for a single week, only consider data from that

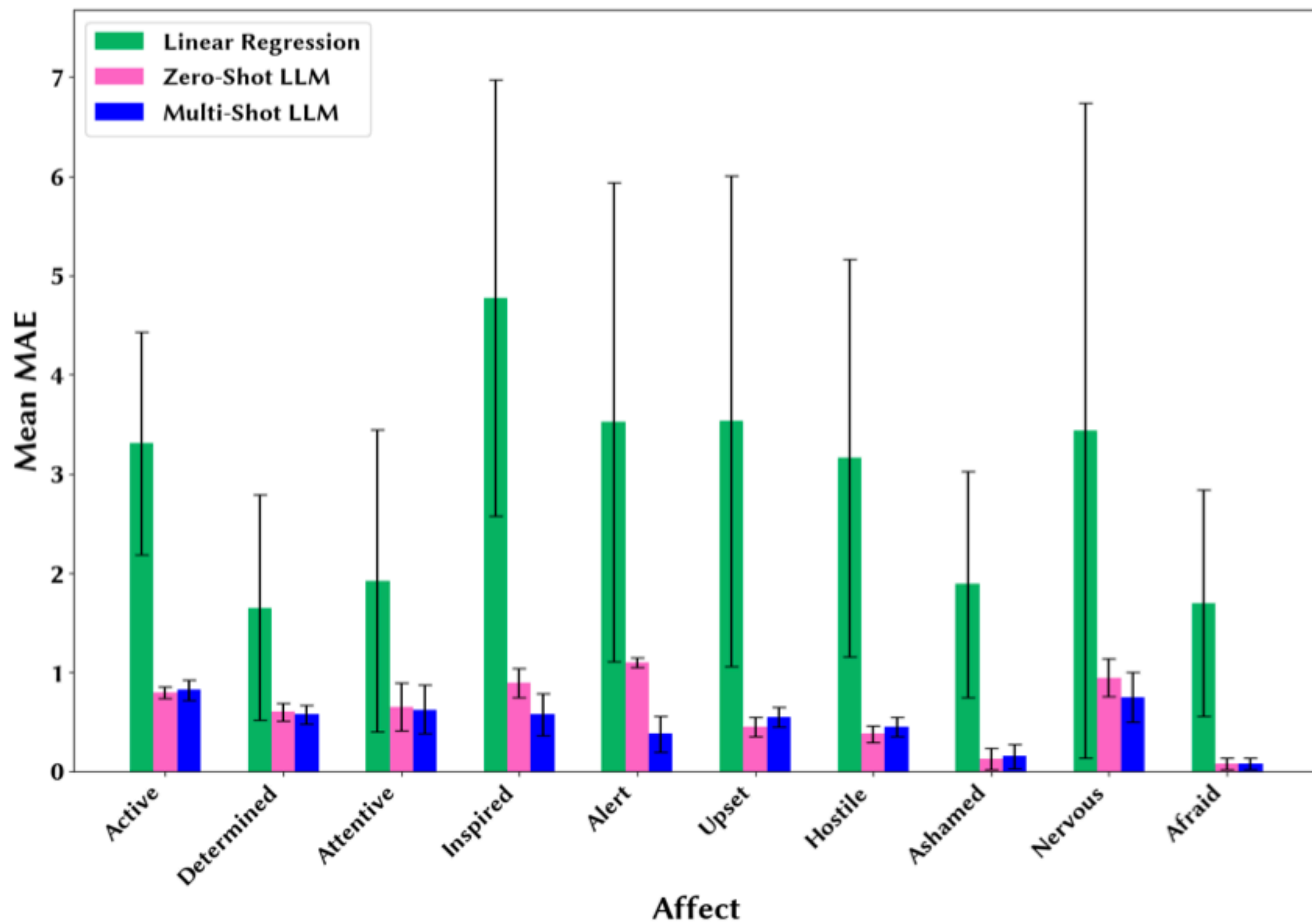

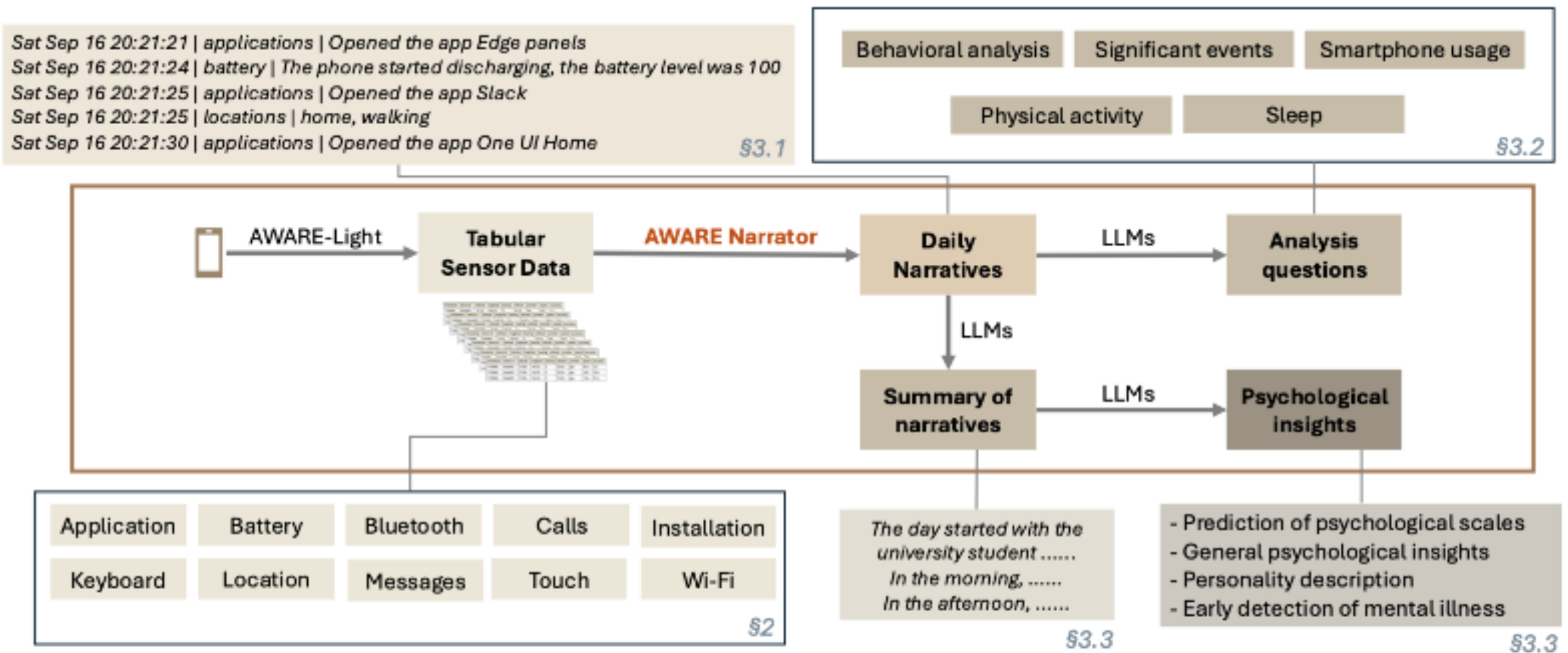

Fig. 1. AWARE Narrator workflow.

# Large Language Models: empowering the study of human behaviour

- Labelling
  - Transcripts, data
- Observations
  - Can describe what's happening in a photograph
  - Can describe what's happening on a user's phone
- Personalisation
  - Personalise interventions
  - Personalise messages
  - Identifying suitable moment to deliver intervention



# Concluding thoughts on what the future holds

- Everyone is obsessed with AI
  - “Give me your data and I will give you gold”
  - Most likely to work well in only some scenarios
  - Robots will not take over the world
- New tech > AI
  - AI needs data, so how do we get better data?
  - How can hospitals generate better data?
  - How to help people/experts generate better data?
- In the future, there will likely be 2 kinds of jobs:
  - Those who tell a computer what to do
  - Those who are told by a computer what to do
  - In both cases, tech needs to be designed for/with humans

# The ~~end~~

# *beginning!*

Prof. Vassilis Kostakos  
vassilis.kostakos@unimelb.edu.au

School of Computing and Information Systems  
University of Melbourne